

SMARTCRAFT SYSTEM SPEEDOMETER INSTALLATION

Components Contained in Kit:

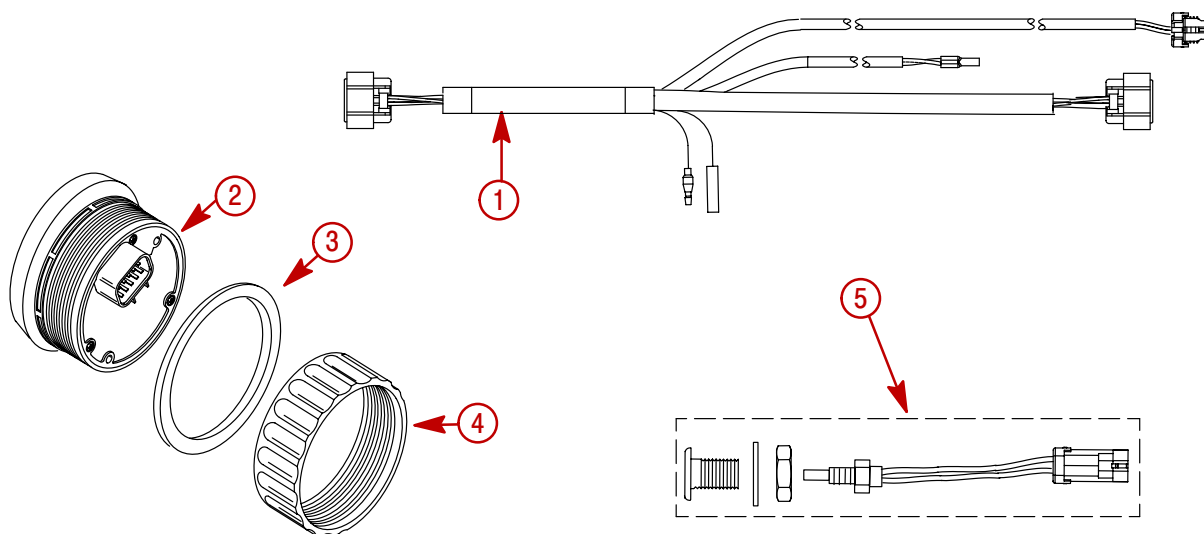

Ref.	Description	Qty.
1	Speedometer Harness (84-879978A1)	1
2	Speedometer Gauge	1
3	Seal 85 mm Dia. (12-859656)	1
4	Retainer Nut (11-859073)	1
5	Outside Air Temperature Sensor Assembly (56-820386-A76)	1

Speedometer Operation and Calibration

Refer to Instructions in one of the following manuals:

1. Operation, Maintenance and Warranty Manual (provided with engine).
2. Engine Installation Manual (provided with engine).
3. Product Service Manual.

Special Instructions

Clean lens with water only.

Installation Information

⚠ WARNING

Disconnect both battery cables at battery before attempting to install gauges

Before cutting any holes, check area behind dashboard for obstructions (braces, cables, wiring, etc.).

CUTTING TIPS

Fiberglass – apply masking tape to area to be cut to prevent dashboard from cracking.

Vinyl Covered – Remove vinyl from area to be cut with razor blade to keep vinyl from tearing.

Gauge Installation

1. Select a location for the gauges that affords good visibility and accessibility from behind dashboard.
2. Drill a 3-3/8 in. (86mm) mounting hole using a hole saw.

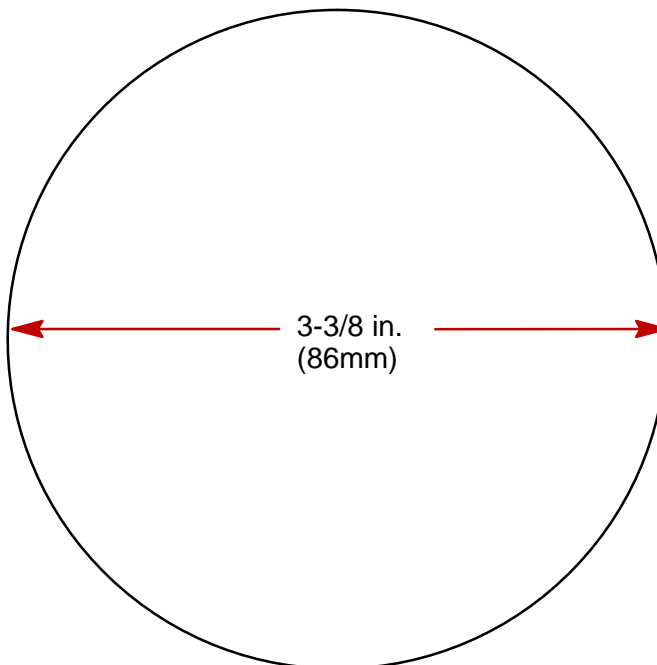

3. Place gauge into dashboard and secure with retainer nut.

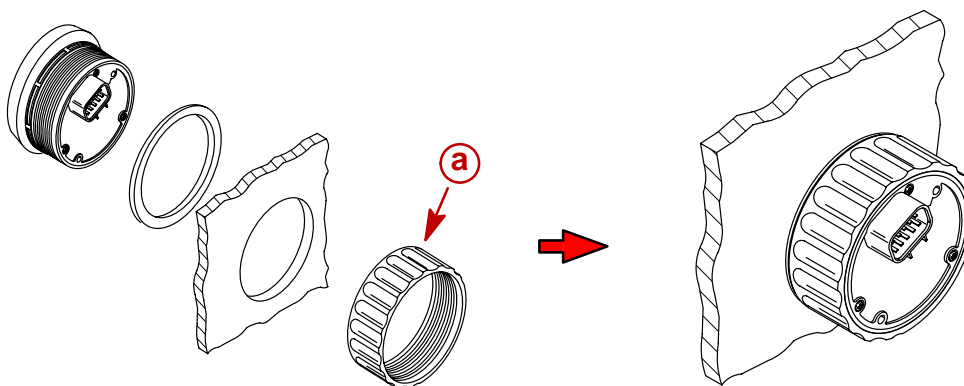

a - Retainer Nut

NOTE: For thick dashboards, reverse the retainer nut for additional thread engagement.

Outside Air Temperature Sensor Installation

1. Mount the sensor where it will be exposed to outside air and will not be in direct sunlight.
2. Select a location and drill a 3/4 in. (19 mm) mounting hole.
3. Install the mounting adaptor as shown.
4. Thread the air temperature sensor into the mounting adaptor.

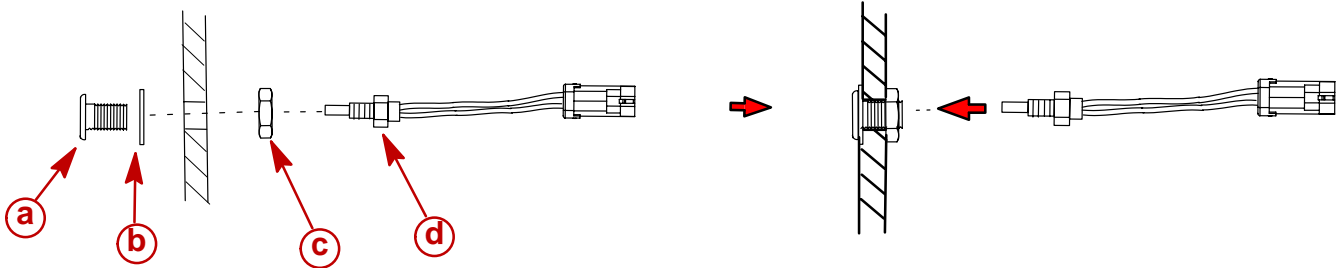

- a** - Mounting Adaptor
- b** - Gasket
- c** - Nylon Nut
- d** - Air Temperature Sensor

Wiring Diagram

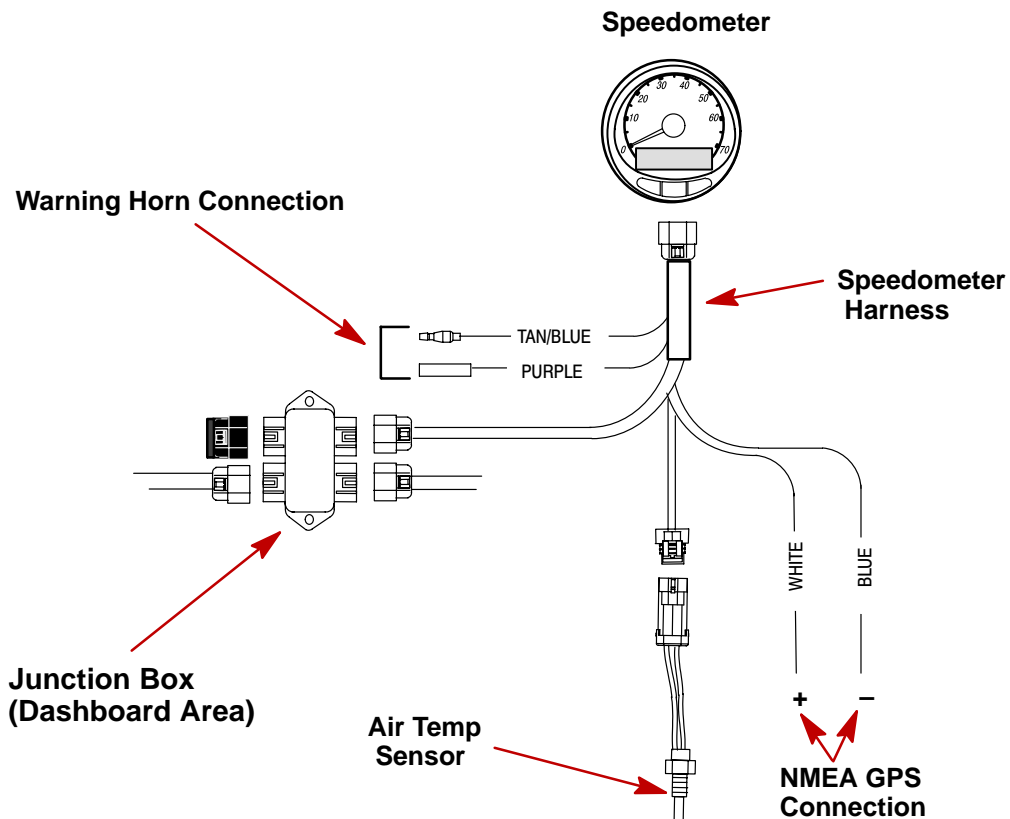

Connecting GPS Unit to the SmartCraft System Speedometer

NOTE: *The GPS unit must comply to the National Marine Electronic Association NMEA 0183 Interface Standard v1.5, v2.0 or later compatible version.*

1. First, look at the GPS wiring diagram and determine what two leads are the GPS output leads. Locate the White and Blue wires coming from the SmartCraft speedometer harness (see wiring diagram). Connect the GPS output leads to the white and blue wires from the speedometer harness. If no data is received, switch the wire connections around. If no data is still received, refer the GPS owner's manual and see if the GPS has to be calibrated to turn on the output signal or needs to be grounded differently.
2. If you want the GPS to automatically set the time, edit the time calibration on the speedometer to enable NMEA.

SMARTCRAFT SYSTEM TACHOMETER INSTALLATION

Components Contained in Kit:

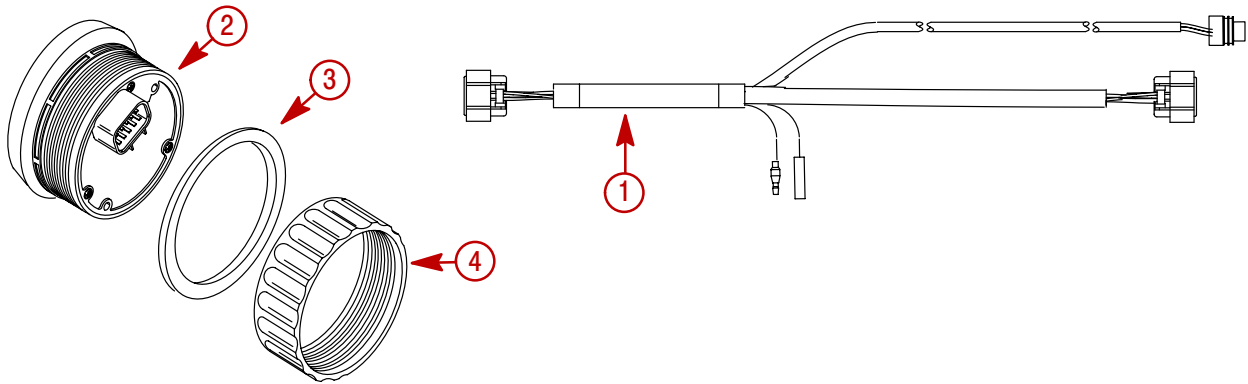

1	Tachometer Harness (84-879979A1)	1
2	Tachometer Gauge	1
2	Seal 85 mm Dia. (12-859656)	1
3	Retainer Nut (11-859073)	1

System Tachometer Operation, Calibration and Wiring Instructions

Refer to Instructions in one of the following manuals:

1. Operation, Maintenance and Warranty Manual (provided with engine).
2. Engine Installation Manual (provided with engine).
3. Product Service Manual.

Special Instructions

Clean lens with water only.

Installation Information

⚠ WARNING

Disconnect both battery cables at battery before attempting to install gauges

Before cutting any holes, check area behind dashboard for obstructions (braces, cables, wiring, etc.)

CUTTING TIPS

Fiberglass – apply masking tape to area to be cut to prevent dashboard from cracking.

Vinyl Covered – Remove vinyl from area to be cut with razor blade to keep vinyl from tearing.

Gauge Installation

1. Select a location for the gauges that affords good visibility and accessibility from behind dashboard.

-
2. Drill a 3-3/8 in. (86mm) mounting hole using a hole saw.

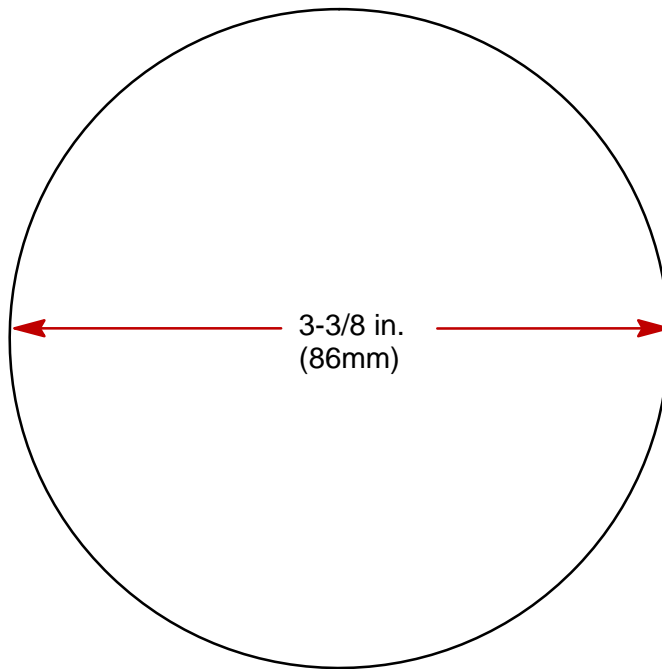

3. Place gauge into dashboard and secure with retainer nut.

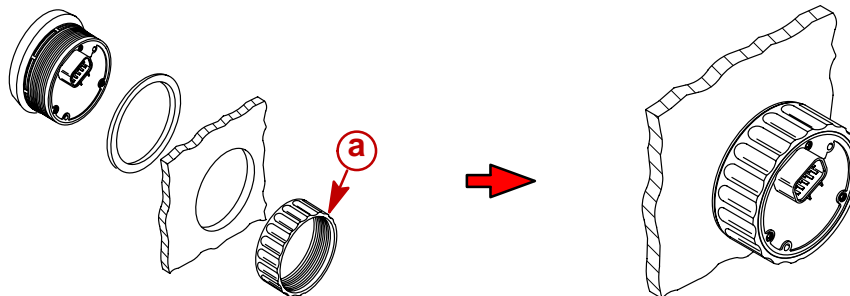

a - Retainer Nut

NOTE: For thick dashboards, reverse the retainer nut for additional thread engagement.

Wiring

